

General Grazing Reserve Information	
Area:	19,536 acres (7,905.9 hectares)
Year Established:	1981
Terrain:	Mainly flat to undulating
Vegetation:	Aspen, balsam poplar, spruce, pine, tame pasture
EcoRegion:	Lower foothills natural subregion
Nearby Municipalities:	9.6 km southeast of Cynthia
Water Bodies:	Pembina River

Livestock Management Information	
Responsible Association:	Pembina Grazing Association (privatized April 1, 1997) Looks after livestock and maintains the developed pastures in good, productive condition. Maintains all fence lines, dugouts, corrals and the buildings at the headquarters site.
Grazing Season:	Mid-May to end of October
Cattle:	Approximately 8,700 Animal Unit Months (AUMs)
Minimum number of Patrons:	21 patrons
Application:	Please contact 780 514-3417 for grazing allotment application. Application deadline is January 31 st .

Within the reserve there are 7,700 acres (3,116.1 hectares) that were developed into tame pasture. The reserve was designed to provide improved habitat for upland and big game, as well as grazing livestock.

Development of the tame pastures, using the integrated resource planning model, was a real challenge given the existence of hundreds of oil wells on the reserve. There's an on-going exploration program, along with winter seismic work. Recreational users are advised to exercise caution when using the access roads in the area as the reserve is situated in the heart of the West Pembina Oilfield.

Provincial Grazing Reserves are popular recreational sites for the general public. Recreational access condition information for Provincial Grazing Reserves can be found at:

- [Recreation on Agricultural Public Land](#)

You must contact the grazing reserve agrologist prior to accessing the reserve at:

- Tel: 780 514-3417

Pemina Provincial Grazing Reserve

Recreational Access Map

Contact Information:
Stew McKay
Phone: (780) 542-6616

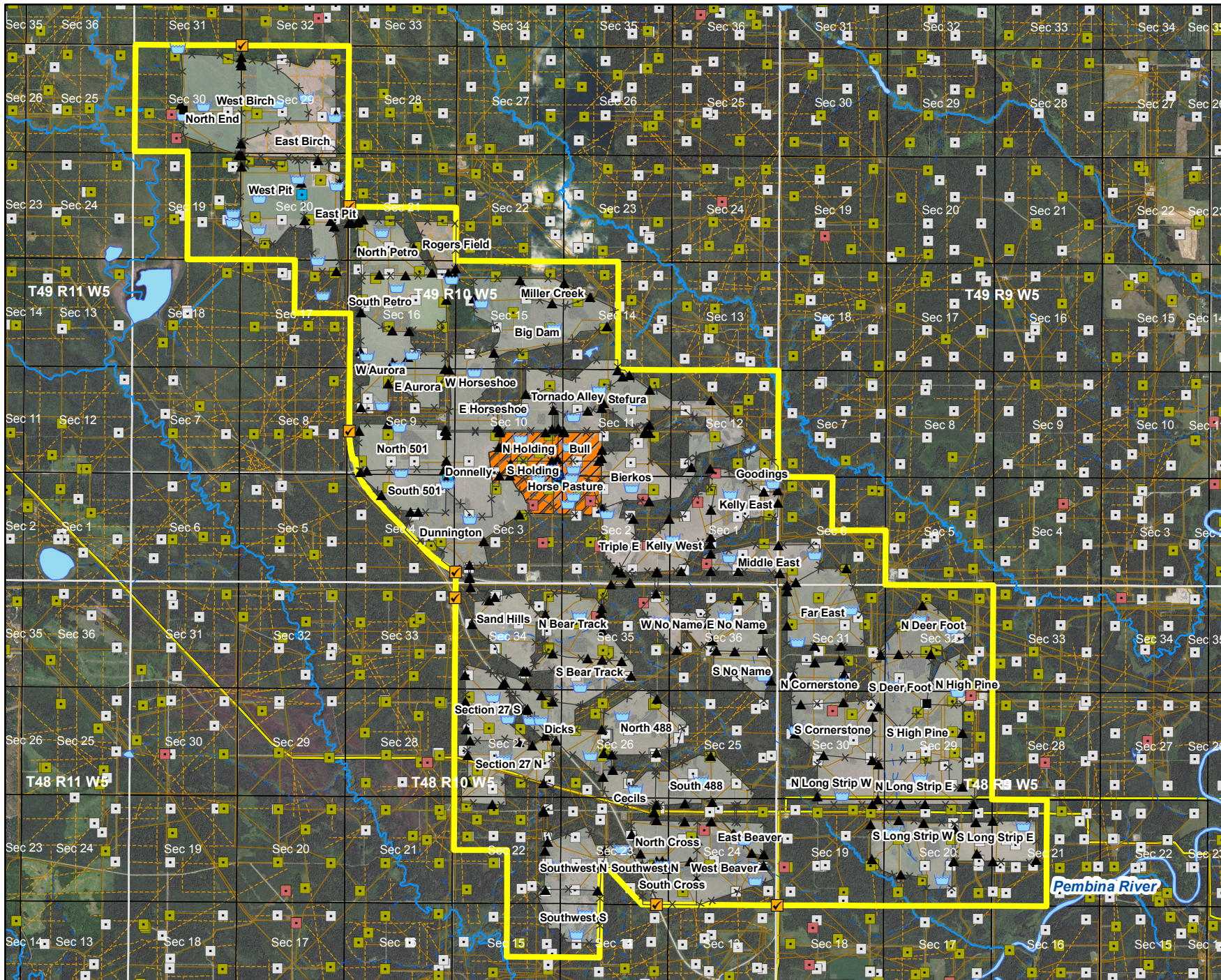

- Public Access
- Headquarters
- Corral
- Cattleguard
- Dugout
- Gate
- Water Well
- Abandoned Well Site
- Well Site
- H2S Well Site
- X Fence
- Outline Trail
- Pipeline
- Power - Transmission Lines
- Permanent Stream
- Recurring Stream
- Township
- Section
- Waterbody
- Restricted Access Area
- PGR Boundary

© 2017 Government of Alberta
Map Created: March 2017
Created by: Range Resource Stewardship Section,
Land Policy Branch, Alberta Environment and Parks

Information as depicted is subject to change, therefore,
the Government of Alberta assumes no
responsibility for discrepancies at the time of use.

Base Map Data provided by the Government of Alberta
under the Alberta Open Government Licence.
© 2015 SPOT Imagery

